

WAYSIDE AMENITIES FOR
BUDDHIST & RAMAYAN
CIRCUITS UNDER SWADESH
DARSHAN SCHEME

TENDER DRAWING

THIS DRAWING IS THE COPYRIGHT OF THE CONSULTANTS AND
MAY BE USED OR REPRODUCED ONLY WITH HIS PRIOR PERMISSION.

GENERAL NOTES:-

1. ALL DIMENSIONS ARE IN MM.
2. DO NOT SCALE ANY DIMENSIONS.
3. CONFIRM LOCATION OF WALLS WITH RELEVANT ARCH. DRGS.
4. FOR R.C.C. WORK USE MIX M25 CONFORMING TO IS 456 : 2000 OR AS SPECIFIED IN RESPECTIVE DWG.
5. THE REINFORCEMENT SHALL BE T.M.T. BARS HAVING YIELD. STRENGTH NOT LESS THAN 500 N/mm² AND CONFORMING TO I.S. 1786 – 2008.
6. THE CLEAR COVER TO THE REINFORCEMENT SHALL BE AS FOLLOWS:-
(a) FOUNDATION
 RAFT BOTTOM : 60 MM
 RAFT TOP & SIDE : 50 MM
(b) COLUMNS : 40 MM
(c) BEAMS (top & bottom): 25 MM side cover 25mm
(d) SLABS : 20 MM
(e) CHAJJAS/CONOPY : 20 MM
(f) R.C.C. WALL : 25 MM
10. THE LAPS IN BARS SHALL BE STAGGERED & AT ONE PLACE SHALL NOT BE MORE THAN 50 PERCENT.
11. ----- INDICATES TOP BARS
 ----- INDICATES BOTTOM BARS
12. READ THIS DRAWING IN CONJUNCTION WITH RELEVANT ARCHITECTURAL DRAWINGS. ANY DISCREPANCY IF FOUND SHALL BE BROUGHT TO THE NOTICE OF CONSULTANT.
13. ALL R C C TO BE MACHINE MIXED AND VIBRATED AND CURED THOROUGHLY AS PER I.S 456-LATEST.

SITE LOCATION
SITE -2A : LUCKNOW-AYODHYA ROAD
SITE -2B : AYODHYA-LUCKNOW ROAD

CLIENT
WAYSIDE AMENITIES FOR BUDDHIST & RAMAYAN
CIRCUITS UNDER SWADESH DARSHAN SCHEME

EXECUTING AGENCY
 HINDUSTAN PREFAB LTD.

TITLE
**TOILET BLOCK
PLINTH & TOP LVL. FRAMING
PLAN.**

DEALT	LALIT TIWARI	DATE 18-12-18
CHECKED BY	RM	SCALE
DRG NO.	ST- 08	

ARCHITECT
M/S ARCHITECT YETINDER MATHUR
U-21 GREEN PARK EXTENSION NEW DELHI
764 SECTOR8B CHANDIGARH

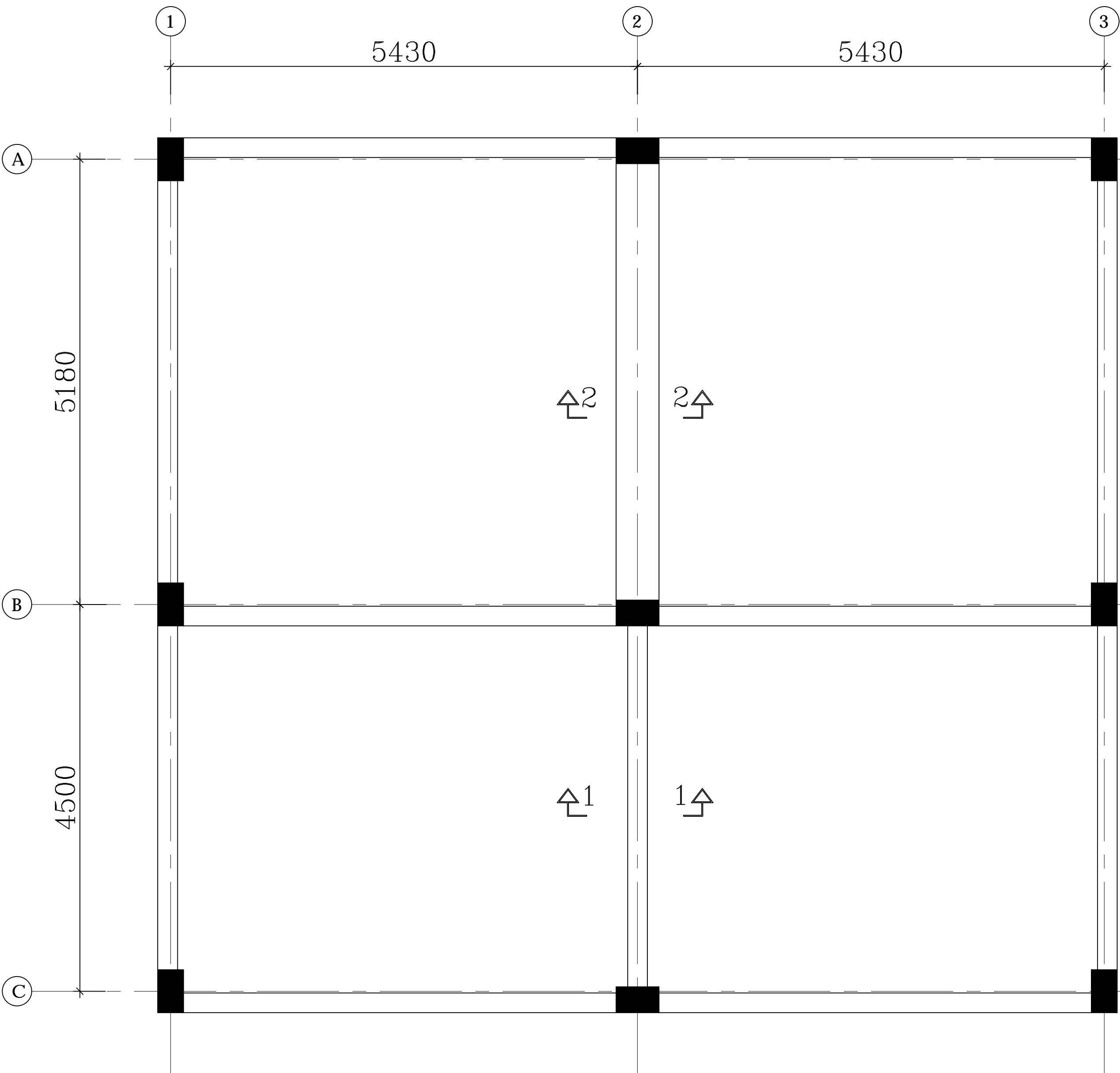

FRAMING PLAN AT PLINTH LVL.
ALL BEAM SIZES (230X450) U.N.O.

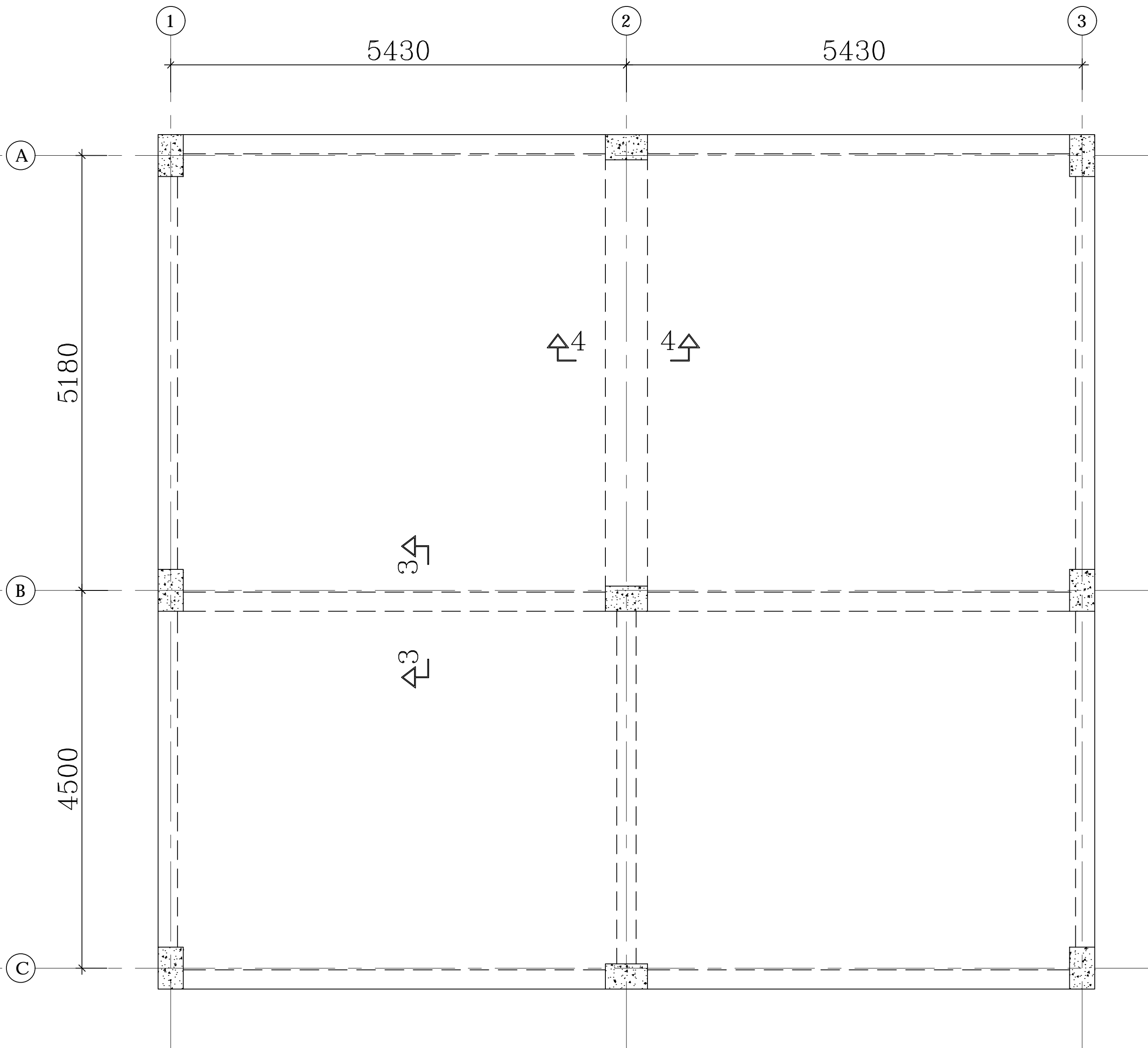

FRAMING PLAN AT TOP LVL.
ALL BEAM SIZES (230X500) U.N.O.
ALL SLAB THICKNESS.150 MM. U.N.O.

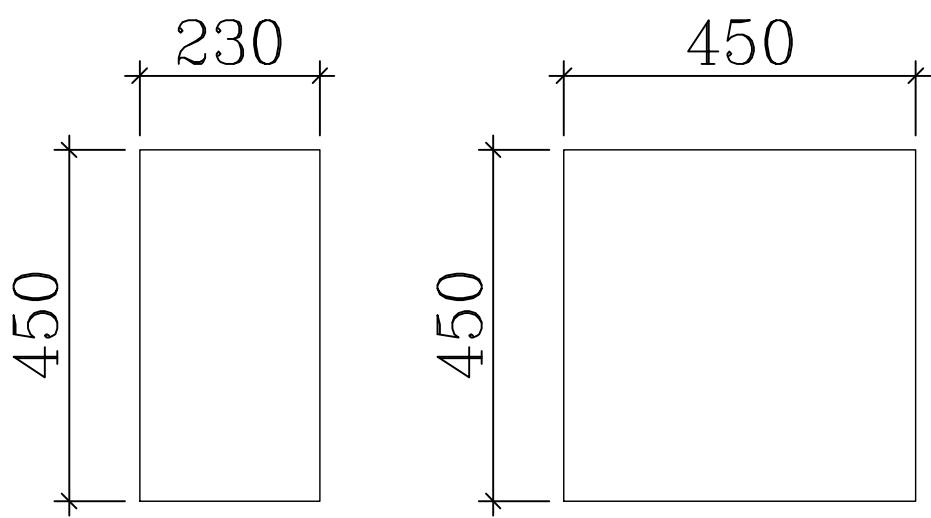

SEC: 1-1 SEC: 2-2

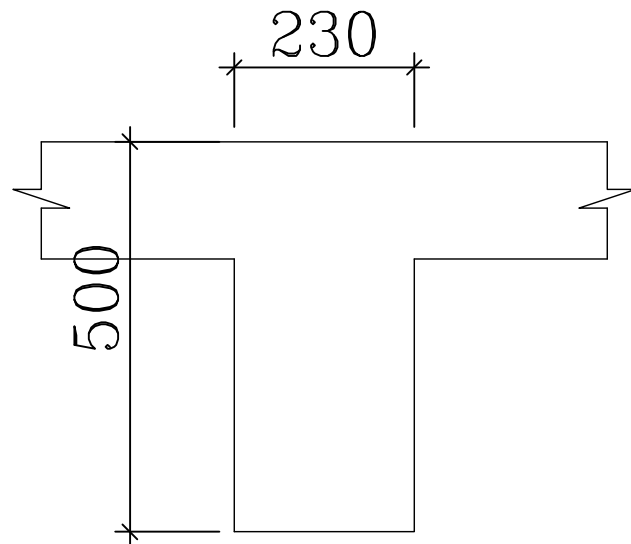

SEC: 3-3

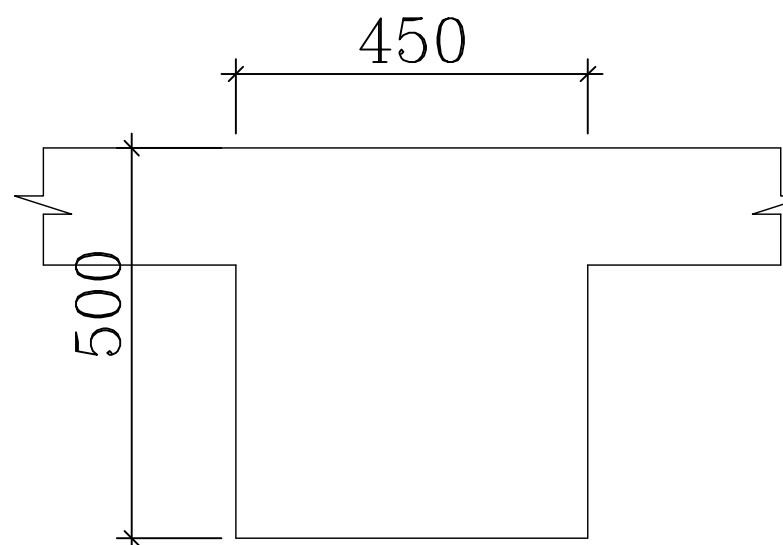

SEC: 4-4